



---

INSTRUCTION MANUAL

Thank you for purchasing a QRT AC power distribution unit. You have just taken a very important step in improving the sound and picture quality of your audio/video system. Please read this manual carefully as the optimum wiring topology will vary with each system, according to the guidelines laid out below. It is important to follow these in order to achieve maximum sonic results.

## PHILOSOPHY

The QRT QBASE AC power distribution units are specifically designed to deliver an optimized, star-earthed, low-Impedance AC supply for any high-quality audio or video system. They do not rely on active circuitry but instead employ superior materials, a tuned mechanical structure and QRT's Focussed Earth technique to provide superior performance, not by improving the AC supply but by avoiding the damage done by other distribution units. The simple solution is normally the best – even if it's not necessarily the easiest to execute. The QBASE stands testament to the power of precision in thinking, design

and construction, with every element being carefully considered.

QBASE Mark II units are available with 4 (QB4) or 8 (QB8) outlets with US, EU (Schuko) or Australian sockets, or 6 (QB6) outlets with UK sockets. The QB8 Mark II and QB6 Mark II units come with either a C-14 or C-20 IEC connector input. When purchasing our UK version, only 6 outlets are available due to the size of the UK sockets. The size of the unit cannot be expanded to fit further sockets because the dimensions of the casework are critical to the units' mechanical performance.

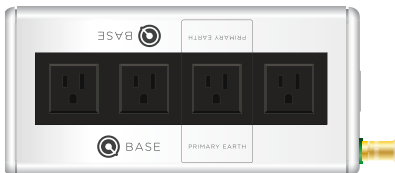

QBASE - QB4 Mark II (US, EU, or AUS)



QBASE - QB6 Mark II (UK)



QBASE - QB8 Mark II (US, EU, or AUS)

# INSTALLATION

## PLACEMENT

In order to deliver its full performance, the QBASE should be placed on a stable solid surface, ideally on a dedicated shelf on an audio rack or amp stand. It should be positioned to allow maximum separation between the system's AC power cords and signal leads.

## CONNECTION

Each QBASE has an IEC input on one end. The unit is symmetrical so that this can be arranged to the left or right as circumstances dictate. In order to install your QRT unit, first switch off your system. Then connect the QBASE to the wall, using a Nordost or other high quality power cord. The system's units should then be connected to the QBASE in the order shown by the diagrams on the left.

It is important to connect the line-

stage or integrated amplifier to the Primary Earth socket located at the center of the ground star. Principal sources should be connected in system order between the AC input and the Primary Earth, balanced by power amp(s) and secondary sources on the other side of this central socket.

While the high-quality WBT binding-post should be connected to an independent clean ground, the system will function as normal without this connection. However, providing a clean signal ground is one of the most cost-effective upgrades you can make to any audio or video system, as well as maximizing the benefits of the QBASE Focussed Earth technology.

Finally, turn on the AC supply to the QBASE, followed by the system components, running from sources first to power or integrated amplifier last. Sit back and enjoy the results.

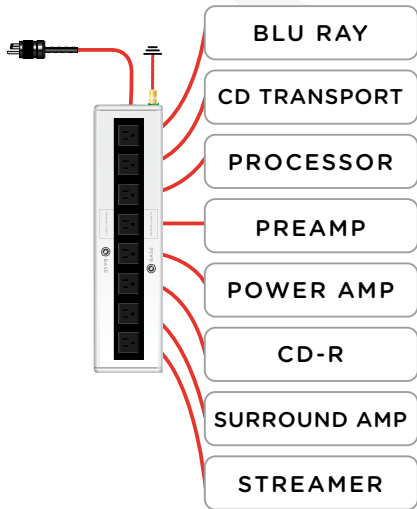
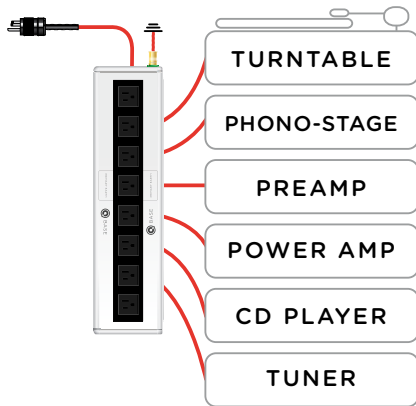
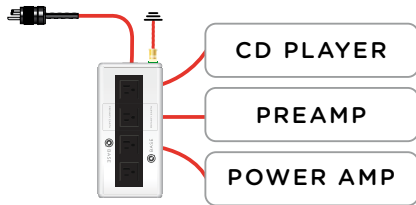

# OPTIMIZING SYSTEM PERFORMANCE

Nordost's other QRT audio enhancers consist of the QKORE Ground Unit, QPOINT Resonance Synchronizer, QSOURCE Linear Power Supply, QX AC Purifier, QVIBE AC Line Harmonizer, QKOIL AC Enhancer, and QLINE Ground Wire.

QRT products are designed to improve the performance of your system, alleviating the impact of poor quality AC and DC power on your sensitive electronics, providing proper grounding, and synchronizing electromechanical resonances.

The effects are cumulative and best heard when QRT products are used as a system. When arranged correctly, the effects include a lower noise floor, increased image depth with tighter focus, wider soundstage, as well as improved overtones, pacing, dynamic range and musical expression.

**QKORE**



**QPOINT**



**QSOURCE**



**QX**



**QVIBE**  
QV2



**QKOIL**  
QK1



**QLINE**



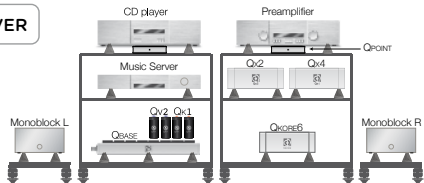
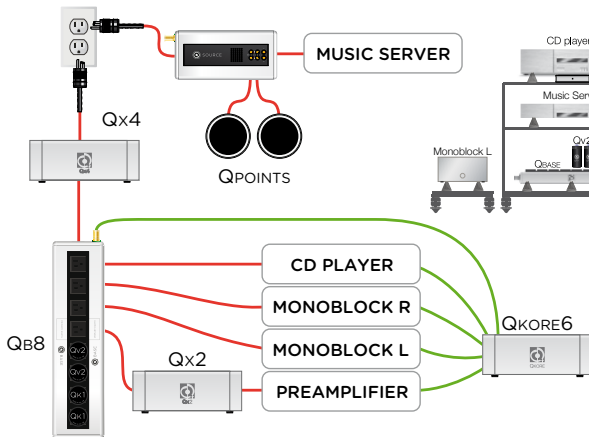
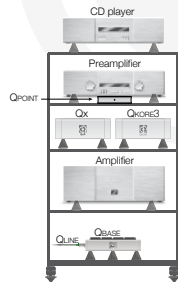
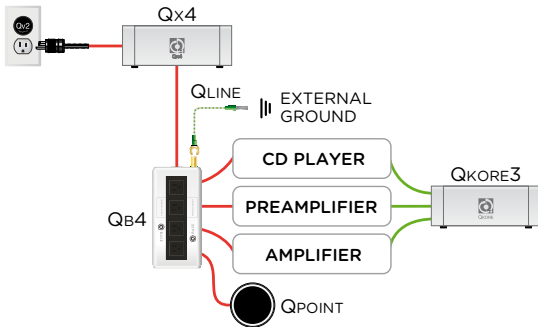

## SPECIFICATIONS

Input Socket: C-14 IEC (15/10 Amp) or  
C-20 IEC (20/16 Amp) (QB8 and QB6 Only)

Output Sockets: US, EU (Schuko), AUS, or UK

Electrical Output: Equivalent to Input

Internal AC/mains fuse: Yes

Dimensions: QB4 (US, EU and AUS): 234 x 67 x 120mm

QB8 (US, EU and AUS): 460 x 67 x 120mm

QB6 (UK): 460 x 67 x 120mm

Weights: QB4: 3.5lb (1.6kg)

QB8: 5.5lb (2.5kg)

QB6: 5.5lb (2.5kg)

---

## WARRANTY

Nordost warrants that the product will be free from defects in materials and workmanship to the original purchaser, under normal use and service, for a period of 5 years. This warranty is not transferable.

**To qualify, please visit [www.nordost.com/product-registration.php](http://www.nordost.com/product-registration.php) and fill out the form, together with proof of purchase, within 30 days of purchase.**

---

**Please Note:** There are no user serviceable parts inside the Qbase units. Opening, tampering with, or modifying the unit in any way could be dangerous and will **VOID THE WARRANTY** on these products.

---